

LA POSTE DU LOUVRE, PARIS, FRANCE

A Case Study

- NF-HQE Rénovation Excellent
- LEED Core & Shell Gold
- BREEAM Very Good

Milliken™

Background

Located in the heart of the 1st arrondissement in Paris, [La Poste du Louvre](#) is a vast mixed-use public and commercial building that houses France's largest post office. Originally built in the 1880s, this monumental historic icon completed a major redevelopment in 2021, with renowned architect [Dominique Perrault](#) leading the project.

The Vision

As part of Perrault's vision for the project, he discussed the concept of restructuring—moving beyond the idea of restoring or preserving a building by envisioning a new story for La Poste du Louvre. This restructuring would undoubtedly restore the functionality of the space and bring it up to standard as the team worked to transform the single-purpose industrial block into an urban block. Restructuring would also prolong the life of the building and broaden the possibilities of La Poste du Louvre—positioning heritage alongside purposeful urban planning.

La Poste du Louvre transformed from a closed industrial building to an open urban complex with a luxury hotel, retail, and residential and office spaces alongside the nation's national postal service.

The duality of the vision, balancing functionality with prolonged purpose, is illustrated poignantly in its design concept. A wide range of design principles were consulted, and this led to the incorporation of building elements like:

- Enhancing thermal insulation and increasing effective solar protection
- Leveraging natural light through architectural glass and natural ventilation with open facades
- Installing rainwater recovery systems and a green roof.

Upon completion, the project achieved leading environmental certifications, marking out the refurbishment within the industry. La Poste du Louvre received [NF-HQE Rénovation](#) (Excellent), [LEED Core & Shell](#) (Gold) and [BREEAM](#) (Very Good) certifications.

The Flooring Approach

Milliken's Flooring Business in France helped conceptualize the La Poste du Louvre workspace designs. The team selected two classic Milliken modular carpet collections—Tracing Landscapes and Crafted Series—which would elevate the space in line with the project's overarching vision while supporting the holistic sustainability value proposition.

Engineered to reduce their impact, Milliken carpet tiles are manufactured with 100% Econyl recycled nylon and 90% recycled polyurethane cushion backings and are covered with [M/PACT™ Carbon Offset Programme](#).

Biophilic Design

The biophilic references throughout its interior soften the industrial skeleton of the La Poste du Louvre building. The organic aesthetic of Geography Lesson from the [Tracing Landscapes collection](#) works harmoniously with the verdant green planting and smooth curving lines of the slatted

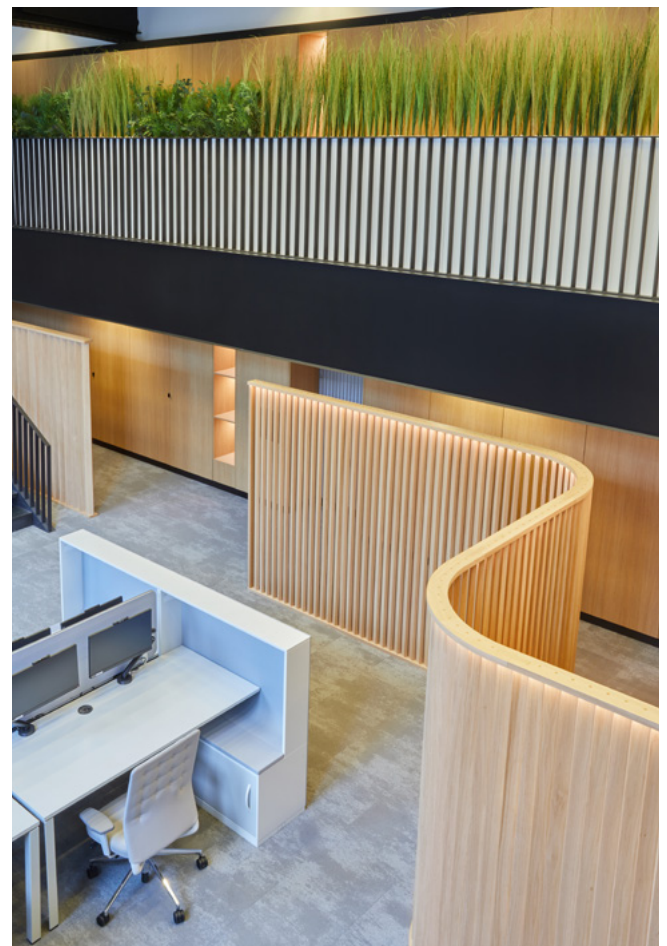

Carpet : Tracing Landscapes – Geography Lessons



Carpet : Tracing Landscapes – Geography Lessons

wood screening. Reflecting the colours, textures, and forms found in the natural environment, Geography Lesson—specified in the pale grey shades of Wind Vane—perfectly complements the furniture in this calm work environment.

As it flows through the corridors, the shifting tones of the carpet’s tufted, textured tip shear finish are luxurious and sophisticated. Its Comfort Lite® cushion backing offers additional underfoot comfort and absorbs wear, extending the life of the carpet and allowing Milliken to offer a 12-year wear guarantee. Adding Milliken’s proprietary soil-resistant finish StainSmart® helps retain the appearance of this light-coloured carpet.

Spatial Zoning

In a striking contrast of colour, the meeting rooms are clearly identified through full-height glass walls. As the perfect counterpoint to the main open office area, the hand-crafted woven look of **Modern Maker**, from Milliken’s Crafted Series collection, is installed in the deep, warm tones of Copper. The

“As it flows through the corridors, the carpet’s tufted, textured tip shear finish is luxurious and sophisticated.”



Carpet : Tracing Landscapes – Geography Lessons



Carpet : Crafted Series – Modern Maker and Tracing Landscapes – Geography Lessons



Carpet : Crafted Series – Modern Maker

timber finishes in these spaces are rich and much darker than the wood panelling outside, which, set against the carpet, evoke a sense of cocooning comfort.

Echoing the style of the meeting rooms, the informal break-out areas in the main office space are defined by the Modern Maker floor covering. The golden and copper colours in the carpet co-ordinate exquisitely with the soft acoustic seating in these spaces.

The acoustic performance of the carpet's WellBAC™ cushion backing also helps people to concentrate more easily by absorbing some of the distracting noise of people moving around and interacting.



Carpet : Tracing Landscapes – Geography Lessons



Carpet : Crafted Series – Modern Maker

- Client** : La Poste du Louvre
- Location** : Paris, France
- Architect** : Perrault Architects
- Interior Design** : CALQ Architecture Agency
- Carpet** : Tracing Landscapes - Geography Lessons, Crafted Series - Modern Maker
- Photo Credits** : Sébastien Veronese

Visit millikenfloors.com for more information.
T +44 (0) 1942 612777 (UK)