

Works with **WELL**™



Milliken™



Project: Admiral Insurance, Cardiff, United Kingdom  
Collection: NORTHERN SOUL

## Milliken's commitment to advancing products and solutions that support human health and well-being is long-standing.

As a founding member of the **Well Living Lab** and a **Well Portfolio Member**, we aspire to design products that enhance the well-being and quality of life of indoor spaces.

We are proud to have been granted The **Works with WELL**™ licence across an extensive selection of our global product portfolio, demonstrating how Milliken floor covering products align with specific strategies in the WELL Standard, the leading global standard for health and well-being.

## About Works with WELL™

The Works with WELL trademark licensing program recognises products and solutions that contribute to achieving specific features in the WELL Standard. Products that have earned the Works with WELL mark have been validated through one or more review cycles to give specifiers the maximum confidence in their material selections, whether working on a WELL-Certified project or simply wanting to ensure they are adopting best practices for healthy, sustainable, people-first spaces for their clients.



# Milliken Floorcovering Works with WELL™

With over 800 product options listed, Milliken's modular flooring works to support the following WELL Building Standard concepts:



**AIR**



**WATER**



**MATERIAL**



**MOVEMENT**



**MIND**

By aligning with up to 14 WELL feature specifications, our products can contribute to the achievement of 14 points and help to meet 2 preconditions.

## Works with WELL™ Concepts and Features



**AIR:**  
Entrance Flooring for  
Pollution Management



**MOVEMENT:**  
Comfort Backing for  
Enhance Ergonomics



**MATERIALS:**  
Health Optimisation &  
Transparency Certification



**Declare.**

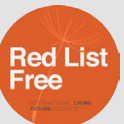

**WATER:**  
Breathable Comfort Backing  
to Manage Moisture

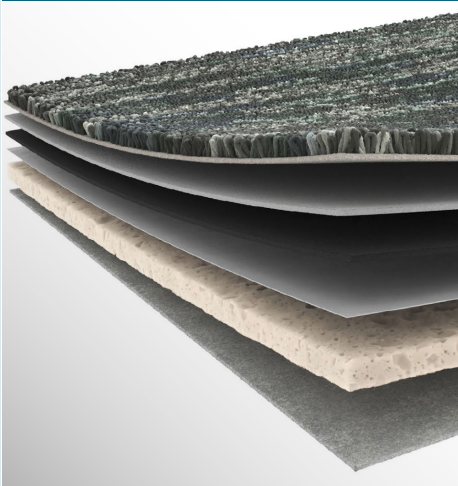

**MATERIALS:**  
TractionBack Glue Free  
Installation for IAQ





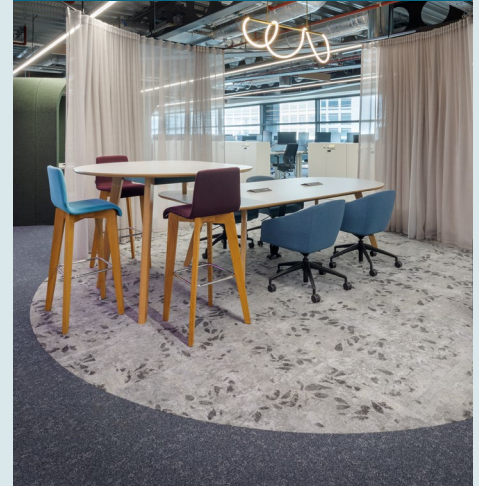

**MIND:**  
Biophilic &  
Neuro-Inclusivity Designs



# Milliken Works with WELL™ Certifications

800 Design and Colour Options across 4 Product Categories

CARPET TILE | LVT | ENTRANCE FLOORING | ADHESIVES

Concept	Feature	Feature Name	Max Points
 <b>Air</b>	A09.1	Pollution Infiltration Management - Design Healthy Entryways	1 Point
 <b>Water</b>	W07.1	Moisture Management - Design Interiors For Moisture Management	1 Point
 <b>Materials</b>	X01.1	Material Restrictions Restrict Asbestos	Pre-condition
	X05.1	Enhanced Material Restrictions Select Compliant Architectural And Interior Products	1 Point
	X06.1	Limit VOCs From Wet-Applied Products	2 Points
	X06.1	VOC Restrictions Restrict VOC Emissions From Furniture, Architectural & Interior Products	2 Points
	X07.1	Materials Transparency Select Products With Disclosed Ingredients	1 Point
	X07.2	Materials Transparency Select Products With Enhanced Ingredient Disclosure	1 Point
	X07.3	Materials Transparency Select Products With Third-Party Verified Ingredients	1 Point
	X08.1	Materials Optimisation Select Materials With Enhanced Chemical Restrictions	1 Point
	X08.1	Materials Optimisation Select Optimised Products	1 Point
 <b>Movement</b>	V02.1	Ergonomic Workstation Design: Provide Support At Standing Workstations	Pre-condition
 <b>Mind</b>	M02.1	Provide Connection To Nature	1 Point
	M07.1	Provide Restorative Space	1 Point

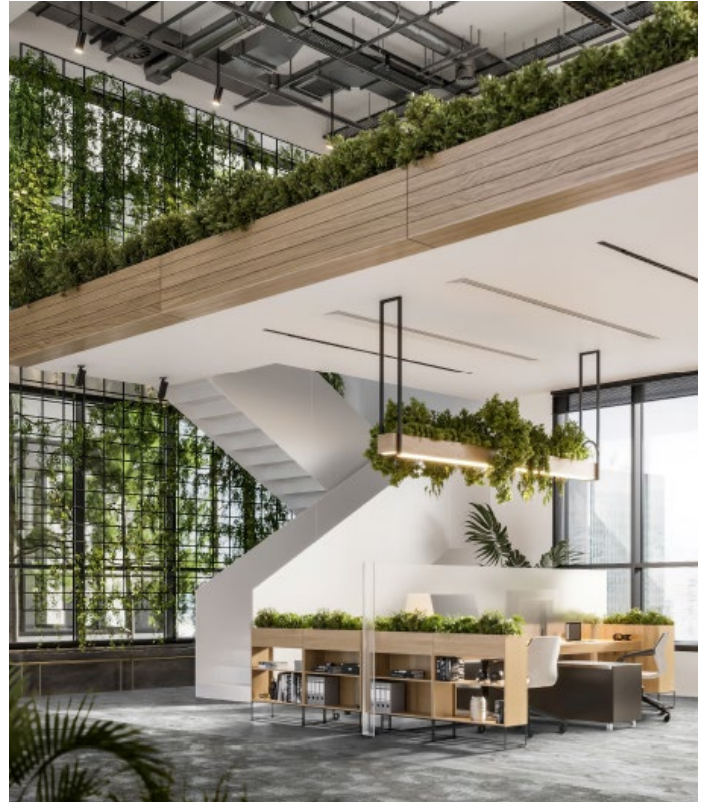

Aligned with up to 14 WELL feature specifications, our products can contribute to the achievement of 14 points and help to meet 2 preconditions.

## WELL™ Certification

Certification represents the highest pinnacle of health achievement across all 10 concepts. Projects must achieve all preconditions, as well as a certain number of points towards different levels of WELL Certification.



40 pts



50 pts



60 pts



80 pts

WELL Certification | WELL Core Certification | WELL Community Certification\*



## Learn more about the WELL standard:

- Book a RIBA accredited CPD session on 'How Floor Covering Impacts Health and Well-being' (in person or online)
- Take a tour of our WELL Platinum certified Studio in Clerkenwell, London
- Contact our team of WELL Accredited Professionals for support with your next WELL Certified project

**Contact us:** [carpetenquiries@milliken.com](mailto:carpetenquiries@milliken.com)



*Project:* Womble Bond Dickenson, Leeds, United Kingdom  
*Collection:* NORTHWARD BOUND

**CUSTOMER SERVICE / SERVICE CLIENT /  
KUNDENSERVICE-CENTER / SERVICIO  
AL CLIENTE**

**UK** — T. +44 (0)1942 612 777  
E. [carpetenquiries@milliken.com](mailto:carpetenquiries@milliken.com)

**FRANCE** — T. 08 05 54 27 77  
E. [demandesmoquettes@milliken.com](mailto:demandesmoquettes@milliken.com)

**DEUTSCHLAND** — T. 0800 7243794  
E. [verkauf@milliken.com](mailto:verkauf@milliken.com)

**ESPAÑA** — T. +44 (0)1942 612 777  
E. [informaciondemoqueta@milliken.com](mailto:informaciondemoqueta@milliken.com)



*Milliken*™